

5

PLACING THE SCREEN FRAME

- 1 - Hold the **screen frame** in the middle of the outer frame
- 2 - Stick the **steel wires** through the tightening-system at the top of the **screen frame**. Secure with the **inbus key 2mm**.
- 3 - Repeat step 2 with the **steel wires** at the bottom.

6

PLACING THE FACETS

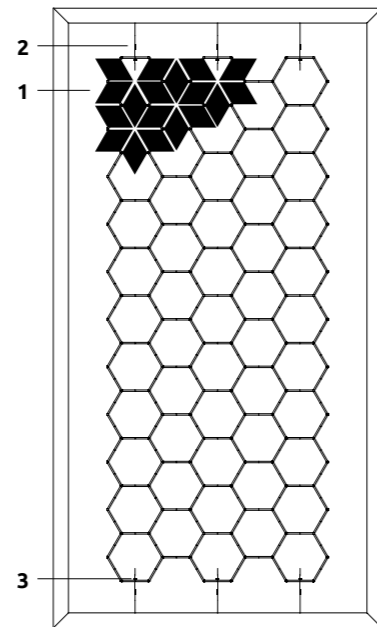

1 - Fill the **screen frame** with the **regular facets**. Start at the top and work your way down to the bottom.

2 - Don't place **regular facets** over the tightening-systems.

3 - When the whole **screen frame** is filled with **regular facets** you can adjust the tightening-system by turning the small wheel to place the **screen frame** with **regular facets** exactly in the middle. Don't give the screen too much tension.

4 - Place the **facets with wire hole** over the tightening-system on a way that the wire comes out of the hole.

5 - Your Facet divider is ready!

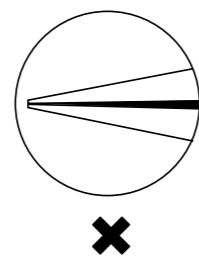

Important!

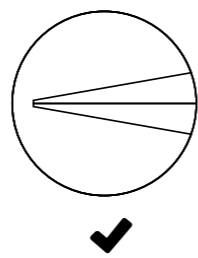
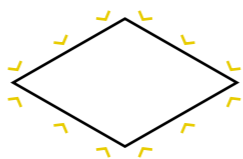

Make sure that the facets are closed over the whole side, all 12 lockpoints, otherwise the frame will not be secured and may fall apart. If a facet doesn't close properly this is occurred because a frame connection isn't closed properly.

Facet / Lightfacet © Blooming - All rights reserved



Enjoy your room divider!



FACET

INSTALLATION GUIDE

blooming
EINDHOVEN

1

CONTENTS

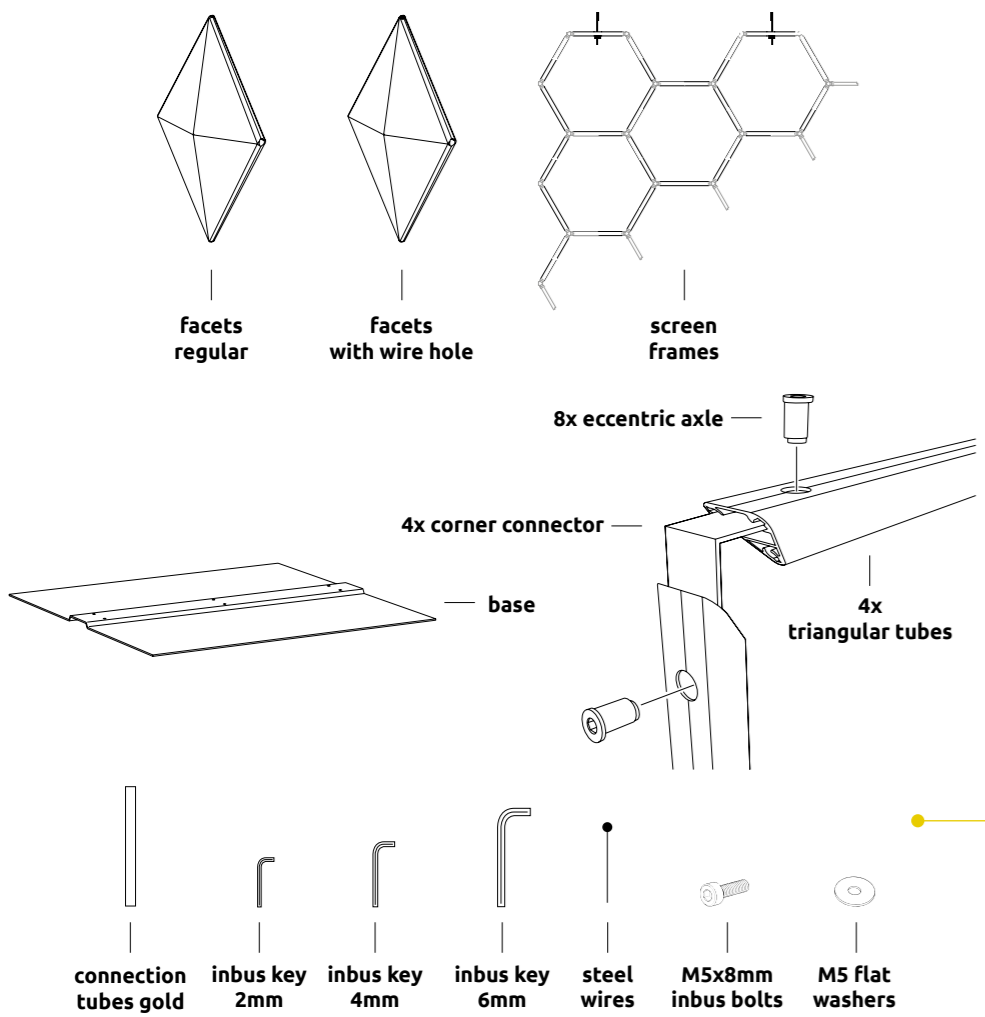

For information or questions visit:
WWW.BLOOMMING.COM

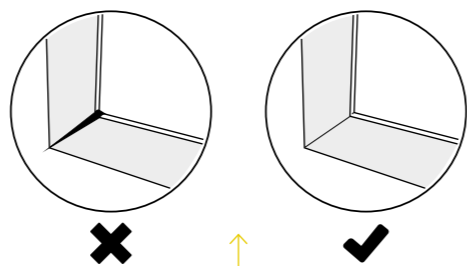

3

ATTACHING THE BASE

- 1 - Turn the outer frame on its side. Hold it steady so it won't fall. Use blankets so the frame won't scratch.
- 2 - Stick the **steel wires** through the frame, from the big holes on the outside through the tiny holes on the inside. Use a piece of tape to make sure they won't fall out again.
- 3 - Attach the base with the **M5x8mm inbus bolts** and **M5 flat washers** and **inbus key 4mm**.
- 4 - Rotate the rectangular frame and put it straight.

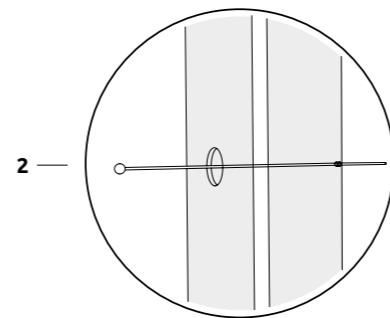
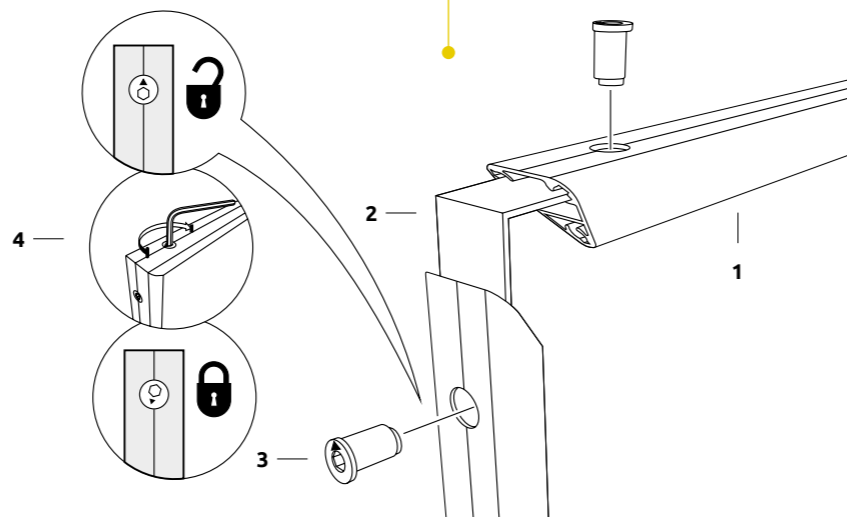

4

CONNECTING THE SCREEN FRAMES

- 1 - Connect the **screen frames** vertical together with the **connection tubes gold**.

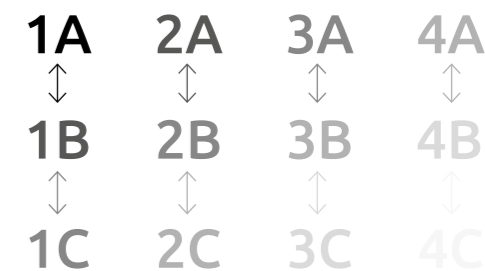

- 2 - Connect the **screen frames** horizontal together with the **connection tubes gold**.



The amount of frame parts depend on the size of your divider.

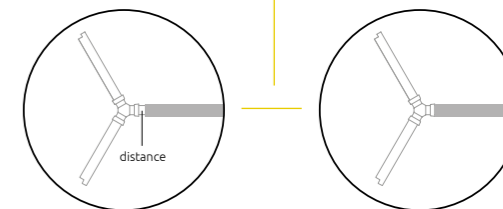

2

OUTER FRAME INSTALLATION

- 1 - Place the **4 triangular tubes** in a rectangle on a flat floor. Use blankets so the **4 triangular tubes** won't scratch.
- 2 - Connect the **4 triangular tubes** with the **4 corner connectors**.
- 3 - Place the **8 eccentric axles** in the corner holes with the arrow pointing towards the corner.
- 4 - Tighten the **8 eccentric axles** evenly with the **inbus key 6mm**.

Please install this product with two or more people

